

# RoHS

| REV | ECN NO. | DESCRIPTION | DESIGN | APPROVAL | DATE       |
|-----|---------|-------------|--------|----------|------------|
| A1  | NEW     | 更换图框        |        |          | 2023.11.25 |

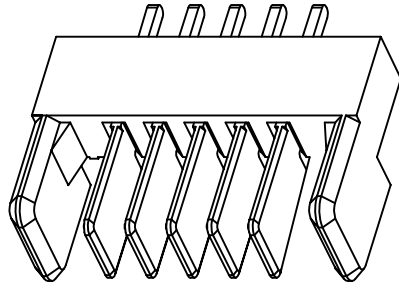

### SPECIFICATIONS

1. Current rating: 7A
2. Temperature range: -40°C ~ +85°C
3. Insulation resistance: 100MΩ Min.
4. Withstanding voltage: 500V AC/ minute.
5. Contact resistance: 30mΩ Max.

### Material:

Insulator Material: PA46 (UL 94V-0)  
 Contact Material: Brass C2680  
 Plating: Nickel Low, gold plated surface  
 Mate with XFCN DCZ05-00F1-3100-A

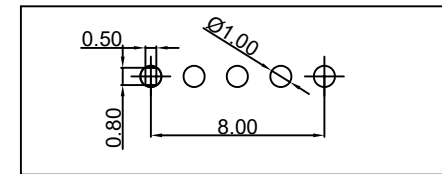
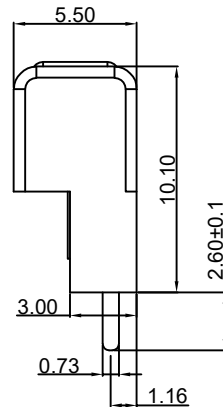
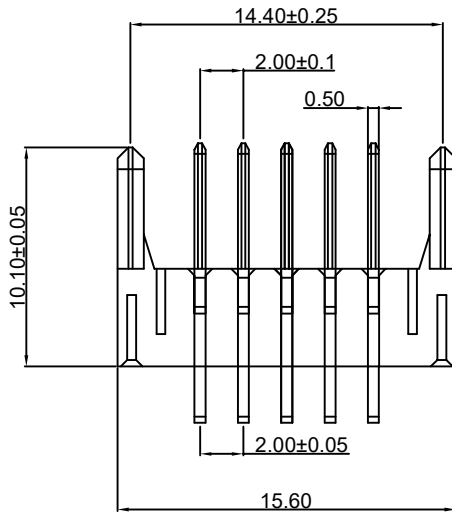

PCB LAYOUT

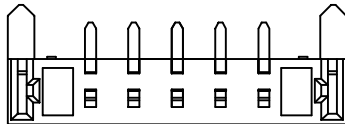

|  |        |          |                |                          |            |                   |     |    |
|--|--------|----------|----------------|--------------------------|------------|-------------------|-----|----|
| X. 0.3   | X.°±   | PART NO: |                | DCZ05-00F1-3010-A        |            | <b>XFCN</b> 兴飞连接器 |     |    |
| .X±0.2   | .X°±   | TITLE:   |                | 2.0mmStand Battery Block |            | 0769-82001899     |     |    |
| .XX±0.08   | .XX°±  |          |                |                          |            | www.xfconn.com    |     |    |
| .XXX±0.03  | .XXX°± | UNITS:   |                | mm                       |            | DWG NO: /         |     |    |
| THESE DRAWINGS AND SPECIFICATIONS ARE THE PROPERTY OF XFCN AND SHALL NOT BE REPRODUCED, COPIED OR CUED IN ANY MANNER WITHOUT THE PRIOR WRITTEN CONSENT OF XFCN |        | APPD     | Chen ZhiQiang  | VIEW                     |            |                   |     |    |
|  |        | CHKD     | Liu Wei        | SCALE                    | SHEET      | REV               |     |    |
|  |        | DRAW     | Chen HongJiang | DATE                     | 2024.08.14 | NONE              | 1/1 | A1 |
|  |        |          |                |                          |            |                   |     |    |
|  |        |          |                |                          |            |                   |     |    |